

SPARE PARTS
FOR
SCOTT
MOTOR
CYCLES
1914



SCOTT ENGINEERING CO. LTD.,
SALTAIRE, SHIPLEY.

Scott Motor Cycle

ERRATA.

- Page 12. No. 217 Starting Device complete
less chain, rod crank and pedal
should be **11/6** each.
- Page 22. No. 387 Grips should be **1/0** each.
- Page 28. No. 558 Saddle Springs should be **1/4** each.
- Page 28. *No. 582 Nail Catcher should be... **1/3** each.
- Page 32. Lucas Acetylene Rear Light
should be **10/6** each.

ADDITIONS.

- Page 8. *No. 160A Half Hubs for 1910,
1911 and 1912 Gears ... **7/6** each.
- Page 12. *No. 264 Silencer Ends ... **1/0** each.
- Page 22. *No. 382 Hub Cups (front wheel) **2/6** each.
- Page 32. *"Silico" Enamel **1/0** per bottle.
- Page 32. *"Club Black" Enamel **6d.** per bottle.

Reliance Spark Plugs are the only suitable Plugs for Scott
Machines. Sets of six can be bought at **3/9**. Single
Plugs, **4/0** each.

Please note when Accessories and Replacements are ordered
to be sent by special train we are obliged to charge **1/0**
extra for special messenger.

Engineering Co., Ltd.,

SALTAIRE, SHIPLEY, YORKSHIRE.

Telegrams: "TWIN, Shipley." Telephone: 337 Shipley,
Two lines.

G.W.H. Scott. Frame 1031, Engine 5521.

Scott Motor Cycle

SPARE PART LIST

1914

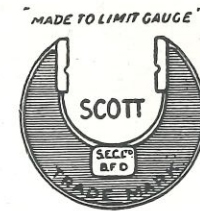

THE SCOTT

Engineering Co., Ltd.,

SALTAIRE, SHIPLEY, YORKSHIRE.

Telegrams : "TWIN, Shipley." Telephone : 337 Shipley,
Two lines.

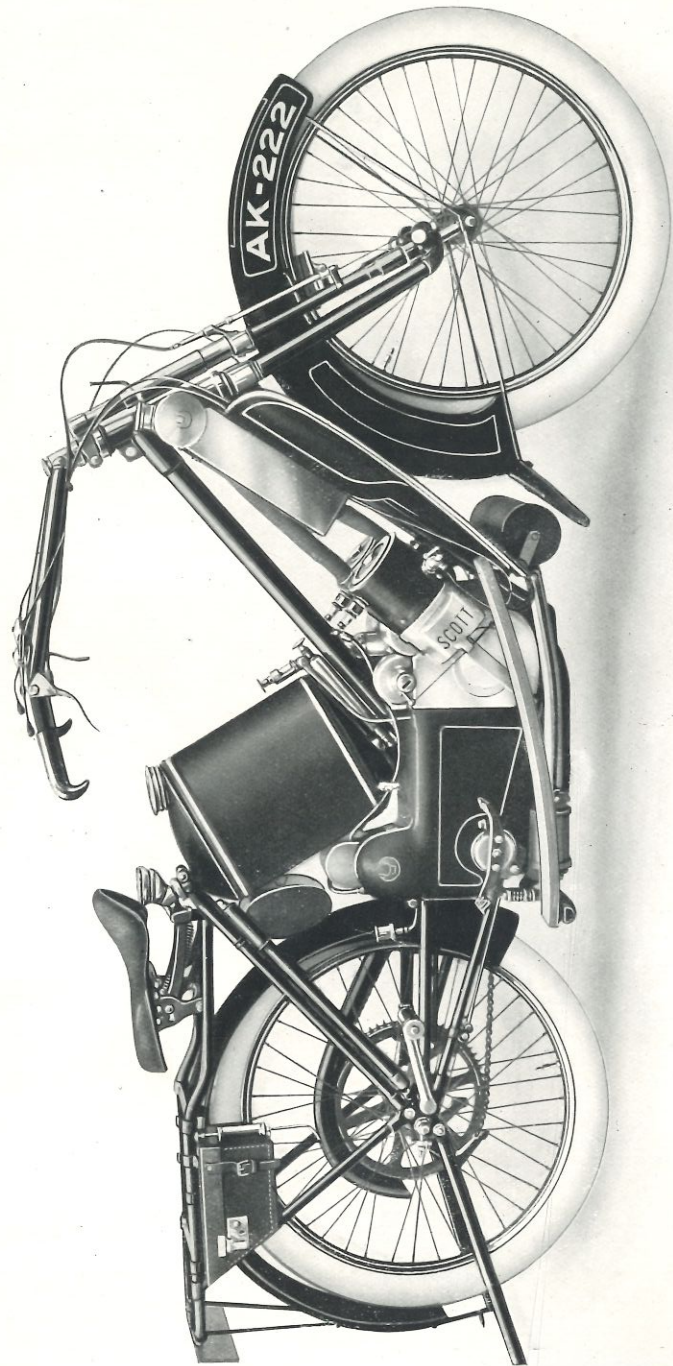

65 Guineas. 1914 SCOTT $3\frac{3}{4}$ h.p. Two Stroke, Two Speed.

INTRODUCTION.

In our 1914 Motor Cycle Spare Part List our aim has been to provide the many riders of our machine with a full and comprehensive list of all parts used in the manufacture of the Scott, together with the prices of those parts.

Since the edition of our 1913 List we have built new and up-to-date works, which will enable us to produce parts in much larger quantities, and to give prompt deliveries.

We wish to impress upon our clients the necessity, when ordering parts, of stating the number stamped on the engine (this will be found on the left hand side of the crankcase, immediately above the word **Scott**) as this will enable us to determine the date of the machine, and so send parts for the proper model.

We also advise our clients to carefully read over our conditions and terms, which will greatly facilitate despatch and avoid mistakes.

We have added a list of accessories which we recommend, and which comprises everything necessary for the regular touring motorist.

We reserve the right to alter the prices in this list without notice.

The parts in this list which are marked with an asterisk (*) are not shown in the illustrations.

THE SCOTT ENGINEERING CO., LTD.,
SHIPLEY.

JANUARY, 1914.

CONDITIONS OF GUARANTEE.

Parts sent to our Works for repair should bear the senders full name and address, and he should furnish us with full and explicit instructions *re* same.

We guarantee our machine and parts manufactured by us for three months from the date the machine is sent out from the works, and we will replace free of charge any part which may prove defective through faulty material or workmanship, on condition that the engine test card is sent when applying for work to be done, or parts to be replaced under guarantee; together with the defective part.

TERMS OF BUSINESS.

1. Nett Cash with order.
2. Stamps cannot be accepted for items of over 1/0.
3. Cheques and postal orders to be made payable to The Scott Engineering Co., Ltd., cheques to be crossed "& Co."
4. Name and address must be written on Telegraph Money Order on Post Office Requisition Form for a private message from remitter to payee.
5. **All postage or carrying charges must be included in remittance. Machines or parts sent to our Works for repair must be sent Carriage Paid, failing this they will be refused by our Stores. All Goods sent from our Works by rail will be consigned Carriage Forward unless sufficient money has been sent to defray the charge.**

DEPOSIT ACCOUNT.

To save delay and ensure delivery by return of parts from stock, we shall be pleased to open a deposit account with customers for £2 or over; on the deposit becoming exhausted it can be renewed to keep the account open. It should be distinctly stated when remitting if the remittance is for Deposit account.

FACTS.

1909 and 1910 engines have been discarded; 1912 engines can be supplied to fit 1909 and 1910 frames.

1909 and 1910 gudgeon pins, piston and connecting rod fastened by screw through top of piston have been discarded; we can supply new piston, gudgeon pin and connecting rod to fit 1909, 1910, same design as 1912.

Piston well blocks have been discarded; we can supply screws to take their place at 6d. per set.

1909 and 1910 radiators have been discarded and we can supply new pattern ready to fit, price £3.

ENGINE.

1	Crankcase	£1 15 0
*2	Crankcase, complete with cups fitted	2 5 0
3	Crankcase Cups	each	...	0 3 6
4	Shrouds	each	...	0 1 0
5	Back Plate	0 0 4
6	Back Plate Screws	per pair	...	0 0 1
7	Inlet Pipe Bush	0 0 3
8	Port Cover Bolt Bushes	each	...	0 0 6
9	Crankcase Doors	each	...	0 2 6
10	Crankcase Door Packing (Acreite)	each	...	0 0 3
11	Aluminium Door Covers	each	...	0 0 9
12	Door Straps	each	...	0 1 3
13	Strap Bolts	each	...	0 0 4
14	Strap Nuts	each	...	0 0 1
15	Strap Wing Nuts	each	...	0 0 6
16	Oil Pipes in Crankcase	each	...	0 0 4
17	Oil Pipe Unions	each	...	0 1 0
18	Oil Pipe Nipples	each	...	0 0 1
19	Large Engine Bolts	each	...	0 0 4
20	Large Engine Nuts	each	...	0 0 2
21	Small Engine Bolts	each	...	0 0 3
22	Small Engine Nuts	each	...	0 0 1
23	Shoulder Nuts	each	...	0 0 2
24	Spring Washers for 21...	each	...	0 0 1
25	Crankcase, complete with Cups, Bushes, Back Plate and Oil Pipes fitted	2 15 6
26	Flywheel...	1 1 0
27	Engine Sprockets	each	...	0 3 6
28	Sprocket Rivets	per set of 4	...	0 0 6
29	Flywheel, complete with Sprockets fitted	1 5 0
30	Flywheel Key	0 1 0
31	Crankshaft Bolt and Left-hand Nut...	0 1 6
32	Right-hand Crank	0 14 0
33	Left-hand Crank	0 14 0
34	Main Bearing Chrome Bushes	each	...	0 0 10
35	Big End Chrome Bushes on Crankshafts	each	...	0 0 9
36	Right-hand or Left-hand Crank, complete with Bushes and Screwed Collar	each	...	0 15 6
37	Main Bearing Rollers (each side)	per set of 12	...	0 2 0
*38	Big End Rollers (each side)	per set of 12	...	0 2 0
39	Packing Glands	each	...	0 2 6
40	Packing Gland Springs	each	...	0 0 4
41	Right-hand Screwed Collar	0 0 3
42	Left-hand Screwed Collar	0 0 3
43	Right-hand Crank Pin Screw, for Left-hand Crank	0 1 3
44	Left-hand Crank Pin Screw, for Right-hand Crank	0 1 3
45	Roller Plates (large hole)	each	...	0 0 4
46	Roller Plates (small hole)	each	...	0 0 4
*47	Thin Crank Washers	each	...	0 0 1
48	Connecting Rods	each	...	0 6 7
49	Big End Chrome Bushes	each	...	0 0 11

ENGINE—continued.

50	Small End Phosphor Bronze Bushes, with 5 BA Screw	each	£0	1	6
51	Connecting Rod, complete with Bushes right-hand or left-hand	each	0	9	0
52	Pistons right-hand or left-hand	each	0	8	0
53	Gudgeon Pins	each	0	2	6
54	Gudgeon Pin Locking Rings	each	0	1	0
55	Piston Rings	each	0	1	6
56	Piston Ring Stops	each	0	0	4
57	Right-hand Piston, complete with Rings, Stops, Connecting Rod, Gudgeon Pin, and Lock Ring		1	5	0
58	Left-hand Piston, complete with Rings, Stops, Connecting Rod, Gudgeon Pin, and Lock Ring		1	5	0
59	Cylinders		2	0	0
60	Head Ring, Rubber Washer	each	0	0	4
61	Head Ring, Steel Washer	each	0	1	6
62	Head Lock Ring	each	0	2	0
63	Head Plugs	each	0	0	6
64	Head Plug Washers	each	0	0	1
65	Brass Water Pipes	per pair	0	0	10
66	$\frac{1}{2}$ Compression Valves, complete with Seating	each	0	2	0
67	$\frac{1}{2}$ Compression Valve Lock Rings	each	0	0	6
68	$\frac{1}{2}$ Compression Valve Actuating Arm		0	1	6
69	Right-hand Exhaust Port Cover Plate		0	1	0
70	Left-hand Exhaust Port Cover Plate		0	1	0
71	Exhaust Port Cover Plate Screws	per set of 4	0	0	2
72	Exhaust Tube		0	0	6
73	Water Tap		0	1	6
74	Water Tap Copper Washers	each	0	0	$\frac{1}{2}$
75	Cylinder holding down Bolt	each	0	0	6
76	Cylinder holding down Bolt Nut	each	0	0	1
77	Cylinder holding down Bolt Pin	each	0	0	$2\frac{1}{2}$
78	Cylinder holding down Bolt, Nut and Pin		0	0	9
*79	Cylinder holding down Bolts, Nuts and Pins	per set of 4	0	2	9
80	Cylinder Base Rubber Rings	per pair	0	0	6
81	Cylinder Base Linen Rings	per pair	0	0	2
82	Transfer Port Covers	each	0	2	6
83	Transfer Port Cover Bolts	each	0	0	2
84	Transfer Port Cover Bolt Spring Washers	each	0	0	$\frac{1}{2}$
85	Leaded Gauzes	each	0	1	0
*86	Leaded Gauzes	per set of 4	0	3	9
87	Acreite Packing for Gauzes	each	0	0	2
*88	Acreite Packing for Gauzes	per set of 8	0	1	4
*89	Leaded Gauze, complete with Acreites fitted	each	0	1	5
*90	Leaded Gauzes, complete with Acreites fitted	per set of 4	0	5	8
91	"Reliance" Sparking Plugs, with Ball Heads and Washers	each	0	4	0
92	Ball Heads for 91	each	0	0	1
93	Sparking Plug Washers	each	0	0	1
94	Cylinders, complete with Head Rings, Water Pipes, $\frac{1}{2}$ Compression Valves, Actuating Arm, Exhaust Port Covers, Rubber and Linen Base Rings		3	15	0
*95	Engine complete		42	10	0

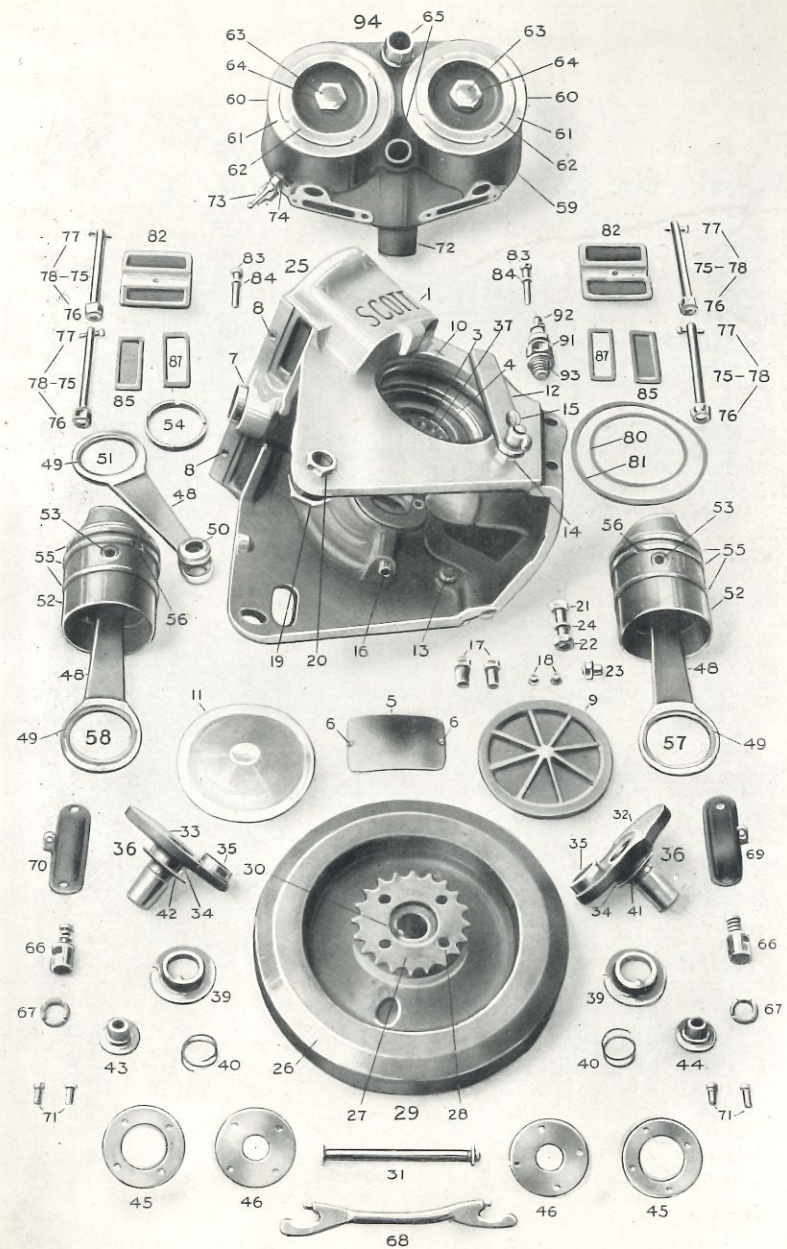

CARBURETTOR.

100	Carburettor complete (less control wires and levers)	...	£1 19 0
101	Carburettor Body	...	0 12 6
102	Float Rocking Lever	...	0 1 0
103	Float Rocking Lever Pin	...	0 0 1
104	Needle complete with Stop and Washer	...	0 0 4
105	Needle Spring	...	0 0 2
106	Needle Valve Seating Nipple	...	0 0 8
107	Needle Guide	...	0 0 6
108	Float	...	0 1 0
109	Float Guide	...	0 0 2
110	Float Guide Milled Nut	...	0 0 2
111	Float Chamber Lid	...	0 0 9
112	Jet Cover	...	0 0 9
113	Jet with Washer (standard)	each	0 0 6
113a	Jet with Washer (large)	each	0 0 6
113b	Jet with Washer (small)	each	0 0 6
114	Throttle Sleeves	per pair	0 3 0
115	Actuating Crank	...	0 2 0
116	Lever Cap	...	0 0 6
117	Lever, complete with Bowden Stop	...	0 1 0
118	Pull-off Spring with Casing	...	0 0 6
119	Throttle Chamber End Cap	...	0 1 0
120	Air Valve, complete	...	0 10 0
121	Air Valve Body	...	0 2 6
122	Air Valve Plunger, Nut and Washer	...	0 1 6
123	Grid Seating with Barrel	...	0 2 0
124	Air Valve only	...	0 0 9
125	Dash Pot Piston Spring	...	0 0 4
126	Pull-off Spring, with Casing	...	0 0 4
127	Dash Pot Screwed Cap	...	0 0 6
128	Air Lever, complete with Bowden Stop	...	0 0 9
129	Air Valve Clamping Screw	...	0 0 2
130	Air Control Screw	...	0 0 1
131	Inlet Pipe, complete	...	0 4 6
132	Inlet Pipe Injection Nipple	...	0 0 9
133	Inlet Pipe Gauze, with Ring	...	0 0 4
134	Inlet Pipe Bush...	...	0 0 3

GEAR.

150	Two-speed Gear, complete with Kick Starting Device, Frame Lugs, Quick-thread Drums and Pedal	...	10 0 0
151	Two-speed Gear complete, without Kick Starting Device, Frame Lugs, Quick-thread Drums and Pedal	...	8 10 0
152	Gear Hollow Spindle	...	0 3 0
153	Thrust Rod with Pin	...	0 1 3
154	Centre Thrust Sleeve	...	0 1 3
155	Centre Thrust Sleeve Cones	each	0 1 6
156	Centre Thrust Sleeve Ball Cages	each	0 0 6
157	Centre Thrust Sleeve Balls	per set of 12	0 0 4
158	Centre Thrust Sleeve Nuts	per pair	0 0 9
159	Centre Thrust Block	...	0 2 6
160	Hub	...	0 12 6
161	Hub Cups	each	0 1 6
162	Hub Cones	each	0 1 6
163	Hub Balls	per set of 13	0 0 6
164	Thrust Lever	...	0 3 6
165	Thrust Lever Screws	each	0 0 6
166	Thrust Lever Squares	each	0 1 0

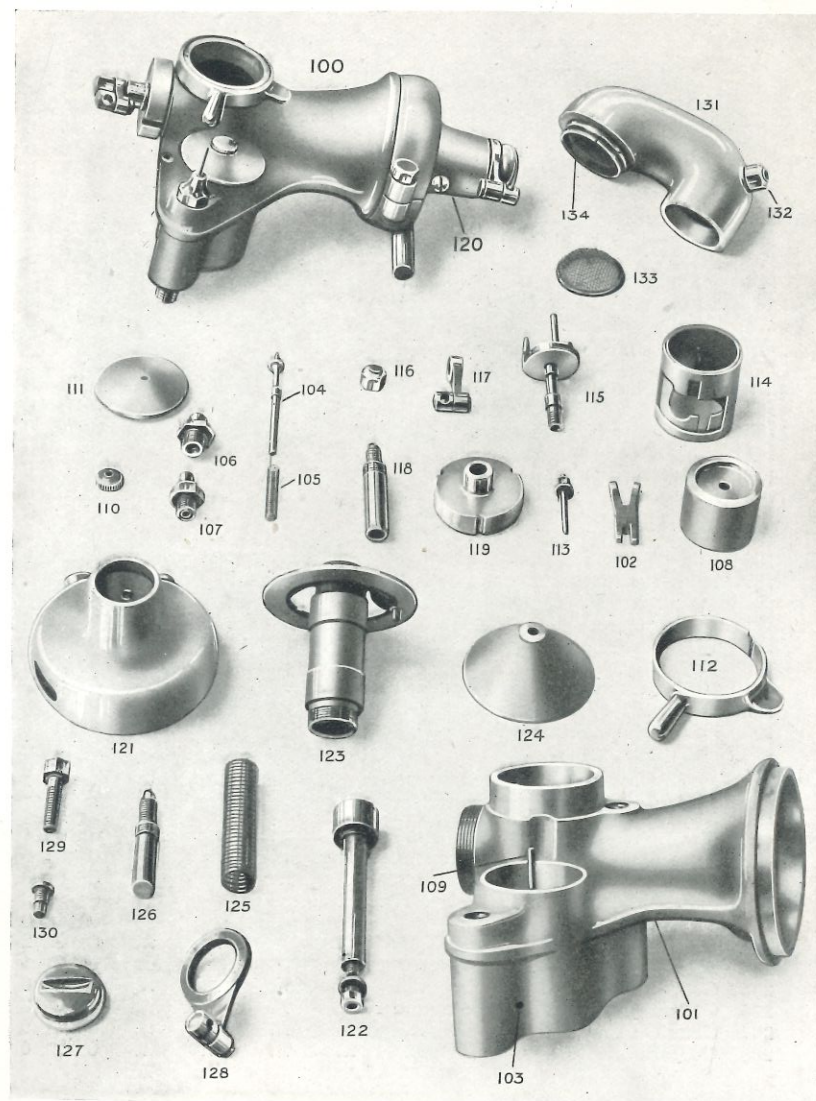

GEAR—continued.

167	High-gear Drum	£0 15 0
168	Low-gear Drum	0 15 0
169	Cages, with Balls	each	0 4 0
170	Expanding Rings	each	0 7 6
171	Side Plates	each	0 2 0
172	Side Plate Distance Washers	each	0 1 6
173	Thrust Rollers	per pair	0 0 9
174	Driving Sprocket 19, 20, 21, or 22 Teeth (state No. of engine)	each	0 3 6
175	Driving Sprocket Lock Ring	0 1 6
176	Lock Ring Set Screw	0 0 1
177	Drum Locking Ring	0 1 6
178	Thrust Ring	0 1 0
179	Ratchet Ring	0 4 6
180	Magneto Driving Sprocket, complete	0 4 0
181	Magneto Driving Sprocket Sleeve	0 5 0
182	High-gear Sprocket	0 7 0
183	Low-gear Sprocket	0 9 0
184	Low-gear Sprocket Plates	per set of 3	0 0 9
185	High-gear Sprocket Rivets	per set of 6	0 1 0
186	Low-gear Sprocket Rivets	per set of 12	0 2 0
187	High-gear Sprocket, complete with Drum, Magneto Driving Sprocket and Crown Ratchet	2 0 0
188	Low-gear Sprocket, complete with Drum	1 7 6
189	R.H. Gear Lug	0 1 0
190	L.H. Gear Lug	0 3 6
191	R.H. or L.H. Gear Lug Centre Blocks	each	0 0 9
192	Taper Pins, Nuts and Washers for Lugs	each	0 0 8
193	Distance Washer between L.H. Lug and Gear	0 0 6
194	Hollow Bolt	0 1 0
195	Inner Quick-thread Drum	0 7 9
196	Inner Quick-thread Drum Locking Nut	0 0 6
197	Adjusting Washers on Thrust Rod	each	0 0 1
198	Spring Washers on Thrust Rod	each	0 0 8
199	Outer Quick-thread Drum, complete with Studs	0 8 6
200	Sleeve Nut on Thrust Rod	0 0 3
201	Adjusting Strap, Bolt, Spring Washers and Nut	0 1 2
202	Strap only	0 1 0
203	Bolt and Nut	0 0 2
204	Spring Washers	per pair	0 0 1
205	Gear Pedal	0 2 6
206	Gear Pedal, Spring Washers and Nuts	per pair	0 0 3
207	Gear Oil Pipe, with Union	0 1 0
208	Gear Lubricator	0 2 0

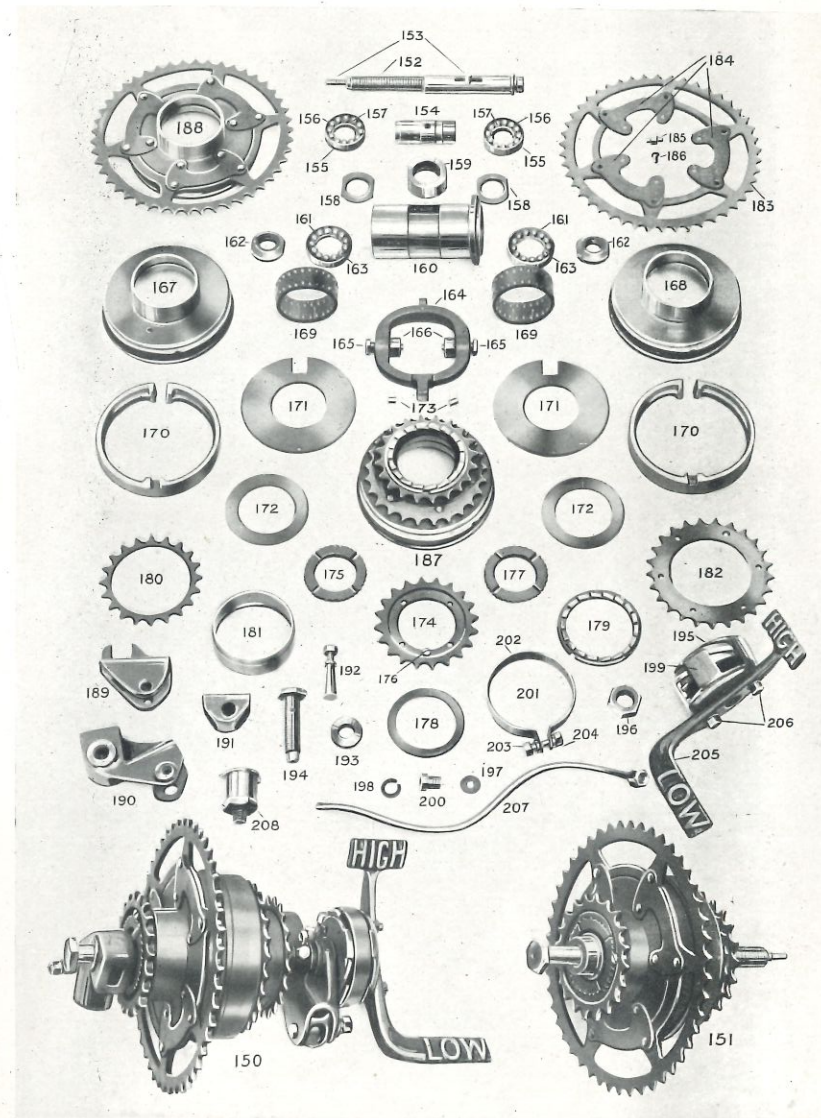

KICK STARTER.

210	Starting Ratchet	0 5 0
211	Starting Ratchet Sleeve	0 1 0
212	Coil Spring	0 0 10
213	Coil Spring Holder	0 1 0
214	Chain Eye	0 0 9
215	Chain Eye Bolt and Coil Spring Rivet	0 0 3
216	Coil Spring Holder Screw	0 0 1
217	Starting Device complete, less Chain, Rod, Crank and Pedal	0 14 6
218	Starting Chain with Bolts and Nuts...	0 1 6
219	Link with Bolt and Nuts	0 1 6
220	Crank	0 5 6
221	Crank Cotter Pin, Nut and Washer	0 0 6
222	Lever	0 4 6
223	Fibre Bush	0 0 6
224	Steel Centre	0 0 4
225	Aluminium End Washer with Bolt	0 0 3
226	Pull-off Spring	0 1 6
227	Pull-off Spring Frame Clip, Bolt and Nut	0 0 3
228	Kick Starter Pedal Stop Clip	0 0 4
229	Kick Starter Rod with Nut	0 1 6

OIL PUMP.

230	Sight Feed Oil Pump, complete with Filter, Oil Pipes and Unions	0 15 0
231	Pump Barrel	0 6 6
232	Plunger	0 0 9
233	Plunger Washer, with Plate and Nut	0 0 4
234	Leather Washer only	0 0 2
235	Pump Base Washer	0 0 1
236	Base with Filter	0 3 6
237	Base Bolts and Nuts	per pair	0 0 3
238	Blind Shoulder Nut	0 0 1
239	Leather Washers for Filter	each	0 0 ½
240	Plunger Spring	0 0 6
241	Gland Nut with Catch	0 0 9
242	Needle Valve	0 1 0
243	Needle Valve Gland Nut	0 0 7
244	Gland Nut Leather Washers	each	0 0 ½
245	Needle Valve Seating	0 0 9
246	Sight Feed Glass with Washers	0 1 0
247	Oil Pipe, L.H. or R.H., complete with Unions	each	0 2 6
248	Oil Pipe Top Unions	each	0 0 2
249	Oil Pipe Top Union Blind Nuts	each	0 0 6
250	Oil Pipe Bottom Nipples	each	0 0 1
251	Oil Pipe Bottom Union Nuts	each	0 0 3

SILENCER.

256	Large Silencer, complete with Bolt and Nut	0 8 0
257	Long Bolt with Nut	0 1 0
258	Hangers	each	0 0 2
259	Drain Pipe	0 2 0
260	Drain Pipe Bracket	0 0 9
261	Small Silencer	0 5 0
262	Set Screw	0 0 1
*263	Silencer Asbestos Washers	each	0 0 3

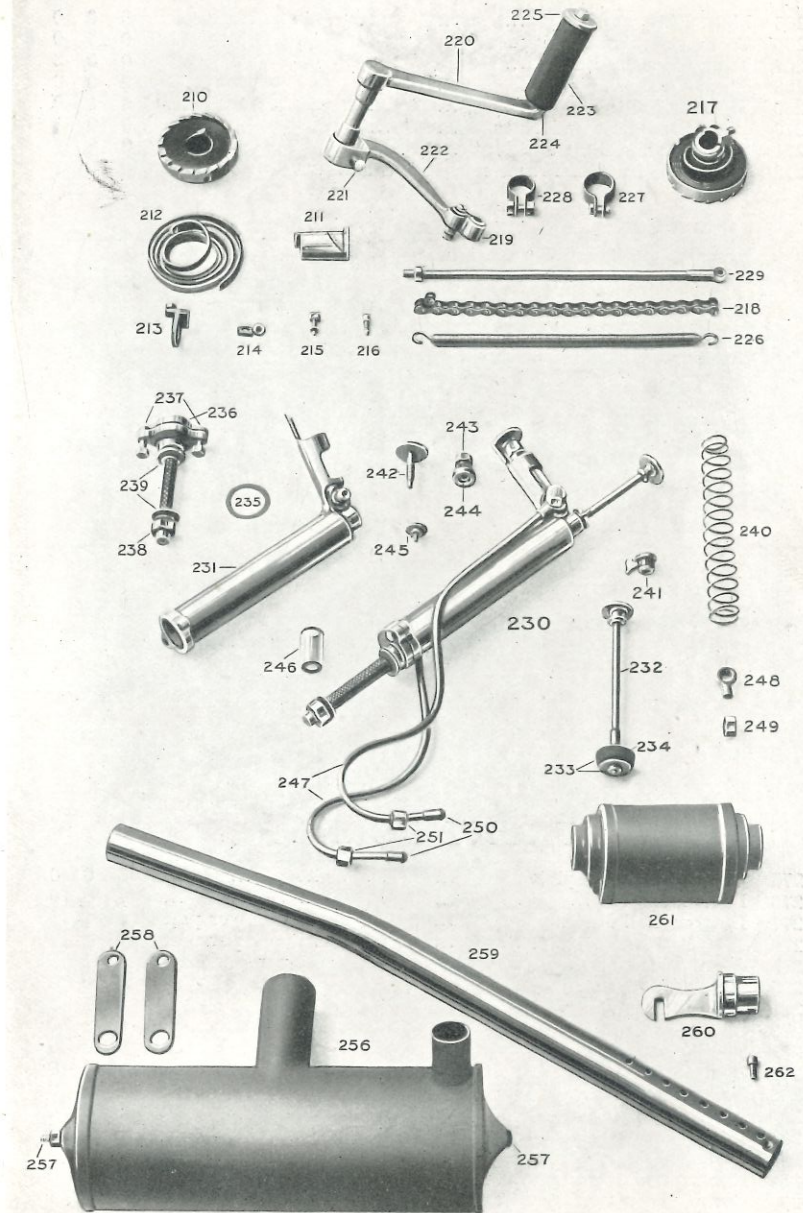

FRAME.

265	Main Frame only	£5	0	0
266	Carrier with Back Stays	0	15	0
267	Tank Washer, Bottom...	0	0	2
268	Tank Washer, Top	0	0	3
269	Tank Lock Ring	0	1	0
270	Back Stay Bolt and Nuts	each	0	0	3
271	Saddle Pillar, Bolt and Nut	0	0	4
272	Bolts and Nuts in Frame for Back Stand	each	0	0	3

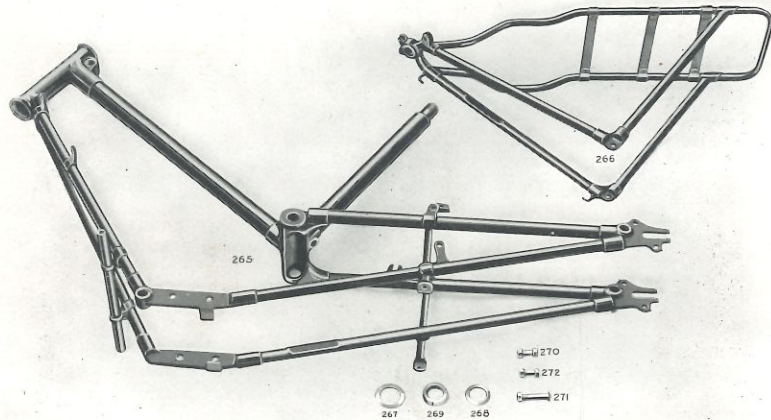

FRONT FORKS.

275	Front Forks, complete	3	0	0
276	Back Member	1	0	0
277	Bottom Ball Races	per pair	...	0	1	9
278	Top Ball Races	per pair	...	0	1	6
*279	$\frac{3}{16}$ -in. Balls	per set of 24	...	0	1	9
280	Head Locking Ring	0	0	9
281	Large Rollers	each	...	0	1	3
282	Small Rollers	each	...	0	1	0
283	Steel Roller Pins	each	...	0	0	6
284	Fork Lubricators	each	...	0	1	0
285	Front Member	1	0	0
286	Inner Spring Case	0	1	4
287	Lamp Bracket, with Spring Case and Head	0	6	0
288	Steering Head, Bolt and Nut...	0	0	4
289	Compression Spring	0	3	0
290	Compression Spring Adjusting Washers	each	...	0	0	1
291	Tension Spring	0	2	0
292	Tension Spring Cap (top)	0	0	8
293	Tension Spring Cap (bottom)	0	0	7

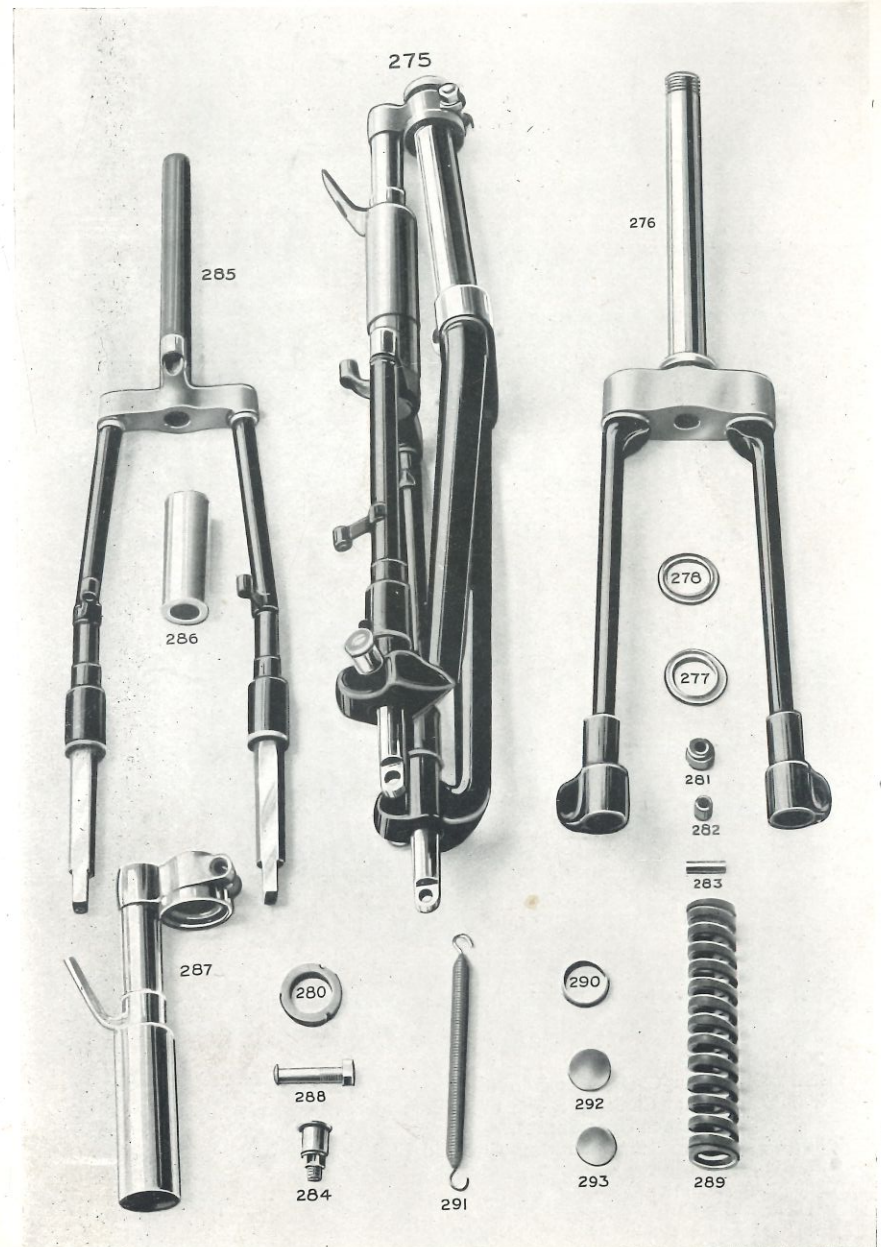

STANDS.

295	Back Stand	£0 10 6
296	Back Stand Shoulder Washers	each	0 0 1
297	Front Stand	0 7 6
298	Front Stand Shoulder Nuts	each	0 0 2

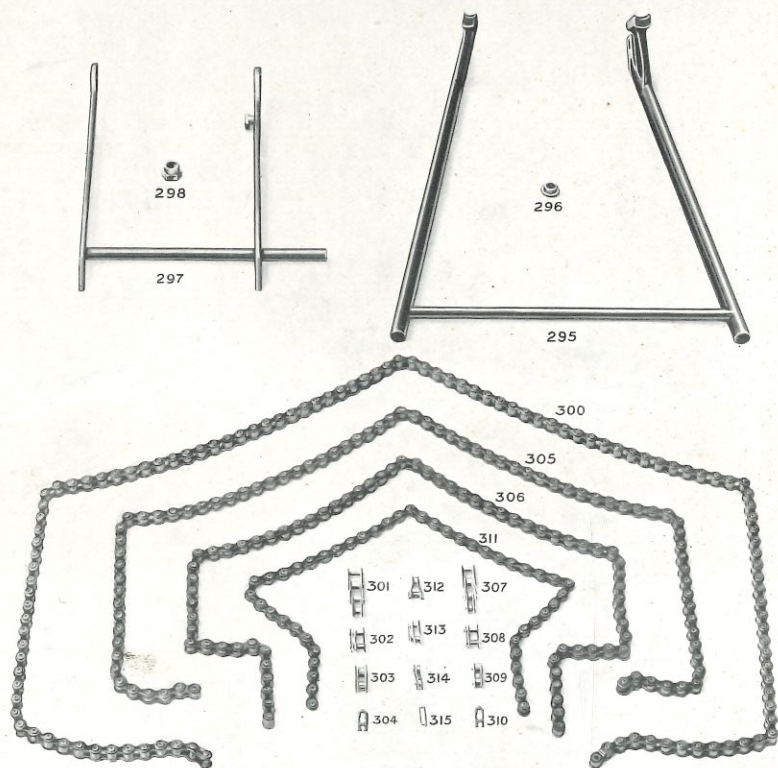

CHAINS AND PARTS.

300	Back Chain, $\frac{1}{2}$ " x $\frac{1}{4}$ ", 115 links	0 9 6
Parts for Back Chain.									
301	Three-link Repair Length, including Cranked Link	0 1 0
302	Spring Link	0 0 5
303	Inner Link	0 0 5
304	Spring Clip	0 0 2
305	Low Gear Chain $\frac{1}{2}$ " x $\frac{3}{16}$ ", 78 links	0 6 4
306	High Gear Chain $\frac{1}{2}$ " x $\frac{3}{16}$ ", 67 links	0 5 6
Parts for Gear Chains.									
307	Three-link part, including Cranked Link	0 1 0
308	Spring Link	0 0 5
309	Inner Link	0 0 5
310	Spring Clip	0 0 2
311	Magneto Chain, $\frac{1}{2}$ " x $\frac{1}{8}$ ", 46 Links	0 3 0
Parts for Magneto Chain.									
312	Cranked Link	0 0 6
313	Spring Link	0 0 5
314	Inner Link	0 0 5
315	Spring Clip	0 0 2

RADIATOR.

320	Radiator	£2 18 0
321	Radiator Bolts, Nuts and Spring Washers	each	0 0 4
322	Radiator Bolts, Nuts and Spring Washers	per set of 4	0 1 2
323	Aluminium Tubing	0 0 6
324	India Rubber Tubing, 18 in.	0 2 6

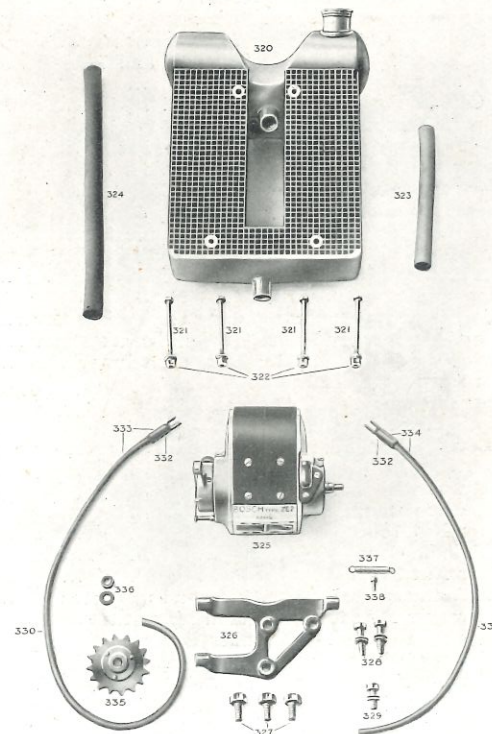

MAGNETO.

325	Magneto only (Type "ZE2")	4 15 0
326	Table	0 3 6
327	Bolts for fixing Magneto to Table	each	0 0 2
328	Bolts with Spring Washers for fixing Table to Frame	each	0 0 3
329	Bolt with Spring Washer for adjusting Table	0 0 3
330	High-tension Wire, long	0 2 3
331	High-tension Wire, short	0 1 11
332	High-tension Plug Terminal	each	0 0 9
333	High-tension Wire, long, complete with Plug Terminal fitted	0 3 0
334	High-tension Wire, short, complete with Plug Terminal fitted	0 2 8
335	Magneto Sprocket	0 2 6
336	Magneto Sprocket Nut and Washer	0 0 3
337	Pull-off Spring	0 0 2
338	Pull-off Spring Bolt, in frame	0 0 1/2

REPLACEMENT PARTS FOR TYPE "ZE2."

53M	Top Fastening Screw for front and rear end plates	...	£0	0	2
54M	Bottom Fastening Screw for front and rear end plates	...	0	0	2
69M	Carbon Holder complete left hand	...	0	3	5
70M	Carbon Holder complete right hand	...	0	3	5
73M	Grub Screw for the connecting cable	...	0	0	2
74M	Carbon Brush	...	0	0	4
75M	Spiral Spring for Carbon Brush 74M	...	0	0	1
76M	Fastening Screw for Carbon Holder 69M and 70M	...	0	0	1
83M	Carbon Brush with Spiral Spring	...	0	0	5
84M	Rubber Cap for Carbon Holder 69M and 70M	...	0	0	2
163M	Short Circuit Terminal in timing lever 185M/188M	...	0	1	5
164M	Screw Bolt for the short circuiting terminal 163M	...	0	0	2
165M	Flat Spring for the short circuiting terminal 163M	...	0	0	3
166M	Mica Piece for insulating flat spring 165M	...	0	0	2
167M	Fibre Piece for insulating flat spring 165M	...	0	0	3
168M	Vulcanite Bush for short circuiting terminal 163M	...	0	0	4
169M	Nut for short circuiting terminal 163M	...	0	0	1
170M	Vulcanite Nut for fastening the short circuiting terminal	...	0	0	7
173M	Cover for Timing Lever 185M/188M	...	0	0	4
174M	Spring Carrier with spring for holding the Timing Lever	...	0	0	7
176M	Oil Cover on the front end plate for right hand magnetos	...	0	0	5
*177M	Oil cover on the front end plate for left hand magnetos	...	0	0	5
178M	Oil Cover for the rear end plate	...	0	0	5
179M	Screw for Oil Cover 176M, 177M and 178M	...	0	0	1
180M	Spiral Spring for Screw 179M	...	0	0	1
*190M	Timing Lever right hand, seen from the driven end for right hand rotation, without accessories	...	0	5	3
193M	Steel Segment with Lubrication	...	0	1	5
194M	Steel Segment without Lubrication	...	0	1	5
216M	Washer for Nut 169M	...	0	0	2
310M	Nut for Spindle Cone	...	0	0	2
311M	Washer for Nut 310M	...	0	0	1
402M	Complete Contact Breaker for right hand magnetos	...	1	1	3
406M	Contact Breaker Disc for right hand Magnetos	...	0	3	5
413M	Fibre Bush for the Contact Breaker Lever	...	0	0	2
417M	Flat Spring for bell crank lever 451M and 452M	...	0	0	2
418M	Washer for the Flat Spring 417M	...	0	0	5
430M	Contact Breaker Fastening Screw	...	0	0	3
434M	Contact Piece for right hand Magnetos	...	0	0	8
435M	Long Platinum Screw	...	0	4	2
438M	Nut for Platinum Screw 435M	...	0	0	1
447M	Fastening Screw for Contact Piece 433M and 434M	...	0	0	1
452M	Bell Crank Lever for right hand Magnetos	...	0	3	5
455M	Short Platinum Screw	...	0	4	2
457M	Fibre Block for Contact Breaker Lever 451M and 452M	...	0	0	2
460M	Contact Breaker Spring	...	0	0	2
461M	Auxiliary Spring on Brass Stud of Contact Breaker Disc	...	0	0	1
462M	Auxiliary Spring on the Bell Crank Lever	...	0	0	1
463M	Fastening Screw for Flat Spring 460M, 461M and 462M	...	0	0	1
464M	Carbon Brush with Spiral Spring for the rear of the contact Breaker Disc	...	0	0	5

NOTE.—When ordering the above spares, please state that numbers are as quoted in the Bosch ZE2 booklet, 1st Edition.

REPLACEMENT PARTS FOR TYPE "ZE2."

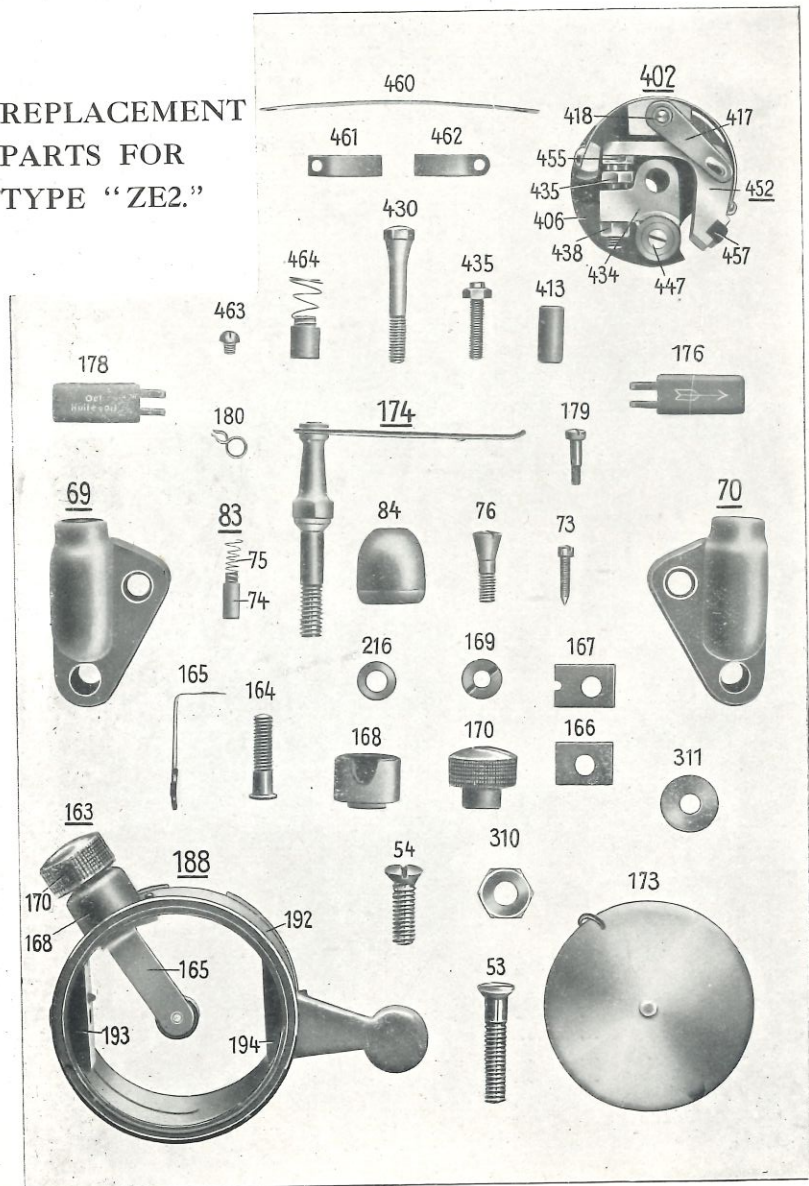

FRONT MUDGUARD.

340	Mudguard Blade with Stays	£0 9 0
341	Front Extension (incorporating front number plate)	0 4 6
342	Mud Flap	0 1 6
343	Mud Flap Clips with Plates each	0 0 3
344	Mud Flap Clip, Bolts and Nuts each	0 0 1
345	Bolts and Nuts holding Flap to Guard	0 0 1

BACK MUDGUARD.

346	Mudguard Blade, including Top Bridge	0 8 6
347	Bottom Bridge	0 0 6
348	Nuts and Bolts for Top Bridge each	0 0 1
349	Carrier Stay	0 1 0
350	Nuts and Bolts for Carrier Stay each	0 0 1
351	Rivets for Bottom Bridge per pair	0 0 ½
352	Stand Clip complete with Bolts and Nuts	0 2 0

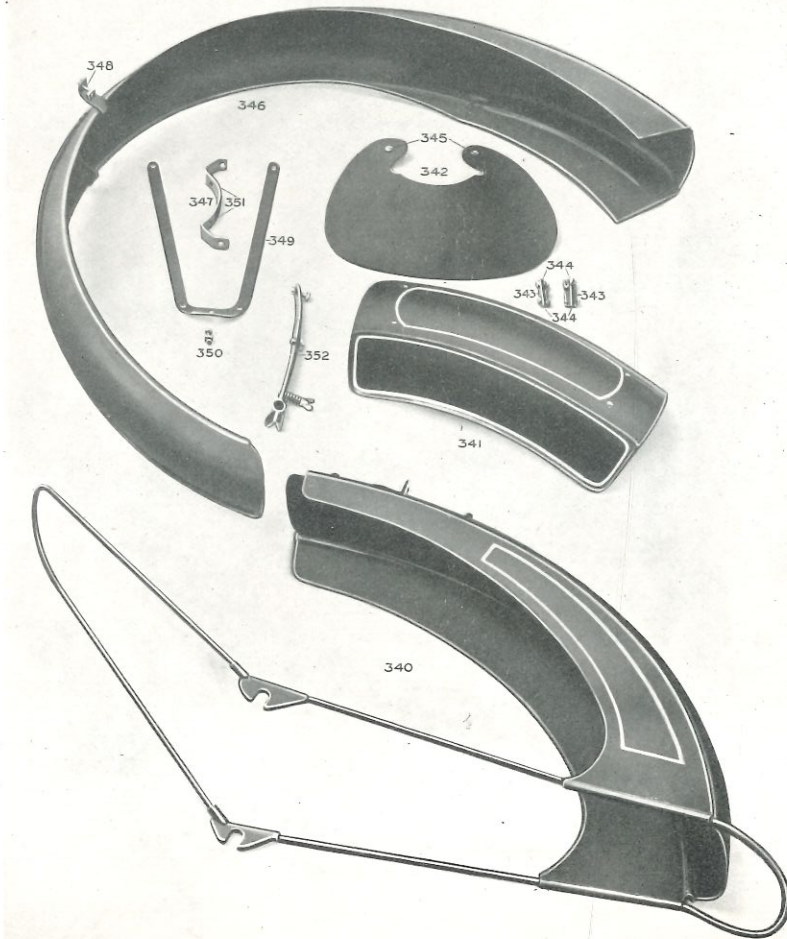

BACK WHEEL.

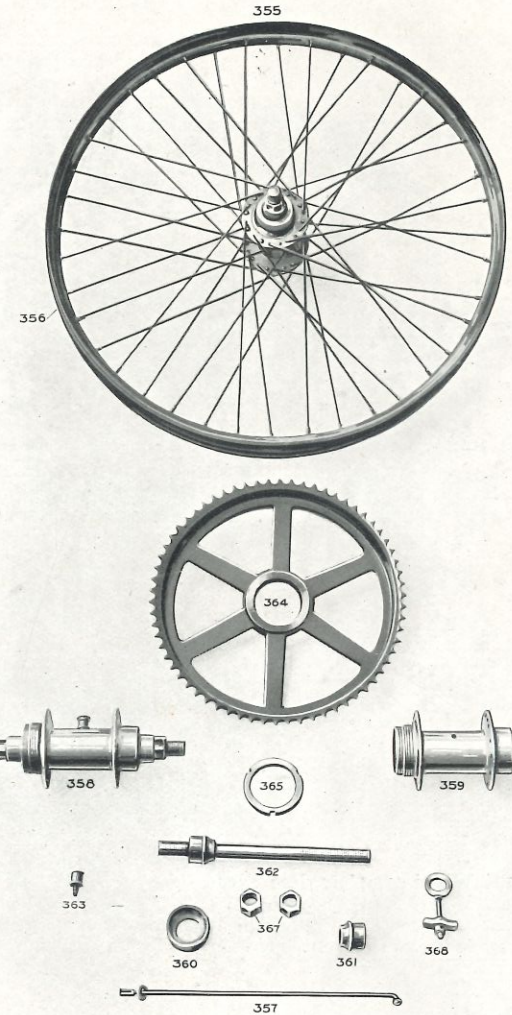

355	Back Wheel complete (less Tyre and Driving Sprocket)	£1 10 6
356	Back Wheel Rim	0 7 0
357	Spokes 10g. with Nipples and Washers per doz.	0 1 0
358	Back Wheel Hub complete, less Sprocket	0 18 6
359	Hub Shell	0 9 0
360	Hub Cups each	0 2 0
361	Hub Cone (adjustable)	0 1 3
362	Axle With Fixed Cone	0 5 6
363	Hub Lubricator	0 0 9
364	Driving Sprocket 66 Tooth	0 12 6
365	Driving Sprocket Lock Ring	0 1 0
*366	¾ in. Balls per set of 24	0 0 8
367	Axle Nuts each	0 0 3
368	Back Wheel Adjusters each	0 0 9

FRONT WHEEL.

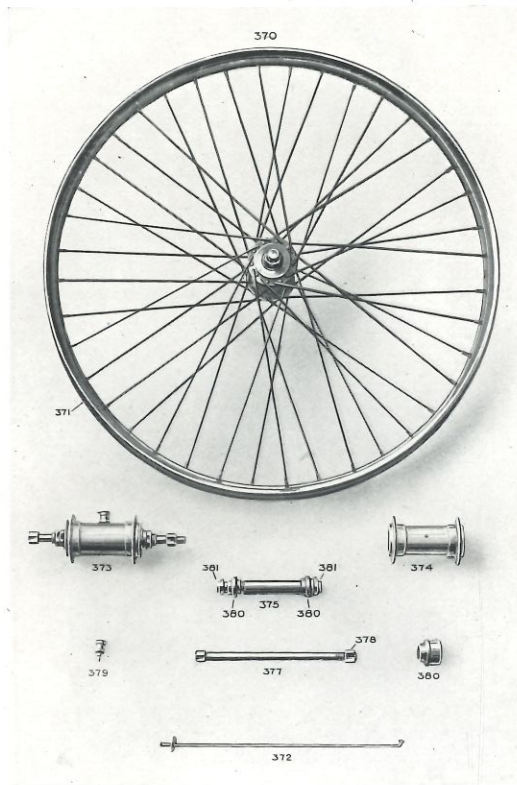

370	Front Wheel complete, less Tyre	...	£1 5 0
371	Front Wheel Rim	...	0 7 0
372	Spokes, 12g. with Nipples and Washers	per doz.	0 1 0
373	Front Wheel Hub, complete	...	0 11 0
374	Hub Shell	...	0 6 0
375	Hollow Spindle with Cones and Nuts	...	0 2 0
*376	$\frac{1}{4}$ -in. Balls	per set of 24	0 0 8
377	Spindle Bolts	...	0 1 0
378	Spindle Nut	...	0 0 1
379	Hub Lubricator	...	0 0 9
380	Hollow Spindle Cones	each	0 1 9
381	Hollow Spindle Lock Nuts	each	0 0 1

HANDLE BARS.

*385	Covered Celluloid Bars, complete with Grips and Crossbar...	0 15 0
386	Covered Celluloid Bars, less Grips and Crossbar and Cap...	0 12 0
387	Grips	each 0 0 6
388	Crossbar	0 2 0
389	Cable Clips, with Screws	each 0 0 6
390	Handlebar Cap	0 0 6

CARBURETTOR CONTROLS.

395	Double Control Levers for Carburettor, complete with Bolt (Scott Patent)...	£0 7 6
396	Control Centre	0 2 3
397	Throttle Lever, complete with Knob	0 2 6
398	Plate between Throttle and Air Lever	0 0 3
399	Air Lever complete with Knob	0 2 6
400	Plate over Air Lever	0 0 3
401	Spring Washer	0 0 2
402	Control Centre Top	0 0 9
403	Centre Top Bolt	0 0 2
404	Bolt for fixing Control to Bar	0 0 3

MAGNETO CONTROLS.

405	Single Control Lever for Magneto, complete with Fixing Bolt	0 5 6
406	Control Centre	0 2 3
407	Magneto Lever complete with Knob	0 2 6
408	Plate over Lever	0 0 3
409	Spring Washer	0 0 2
410	Control Centre Top	0 0 9
411	Centre Top Bolt	0 0 2
412	Bolt for fixing Control to Bar	0 0 3
413	Vulcanite Knob with Washer for Throttle, Air or Magneto Lever	0 0 3

$\frac{1}{2}$ -COMPRESSION CONTROL.

415	$\frac{1}{2}$ -Compression Lever, complete with Spring Peg for Switch	0 5 6
416	Lever Centre	0 2 6
417	Lever only	0 2 0
418	Centre Bolt	0 0 2
419	Washer	0 0 1
420	Spring Peg, with Fixing Ring	0 1 6

SWITCH PARTS.

421	Switch Pin, complete with Fibre Washers and Nut	0 0 7
422	Switch Pin only	0 0 3
423	Nut	0 0 $\frac{1}{2}$
424	Fibre Washers	per pair 0 0 3
425	Steel Tube (bush)	0 0 2
426	Steel Washer	0 0 $\frac{1}{2}$
427	Switch Wire, complete with Terminal	0 2 0
428	Switch Wire only	0 1 10
429	Brass Terminal	0 0 2

BOWDEN WIRES AND CONNECTIONS.

430	Throttle Wire complete with Casing and Nipples	0 2 0
431	Throttle Wire (inner)	0 0 8
432	Throttle Wire (Casing)	0 0 9
433	Air Wire complete with Casing and Nipples	0 2 0
434	Air Wire (inner)	0 0 8
435	Air Wire Casing	0 0 9
436	Magneto Wire, complete with Casing and Nipples	0 2 6
437	Magneto Wire (inner)	0 1 0
438	Magneto Wire Casing	0 1 3
439	Special Nipples for "Scott" Patent Control Levers, each	0 0 $\frac{1}{2}$
440	$\frac{1}{2}$ -Compression Wire, complete with Casing and Nipples	0 1 6

BOWDEN WIRES AND CONNECTIONS—continued.

441	$\frac{1}{2}$ " Compression Wire (inner)	£0	0	6
442	$\frac{1}{2}$ " Compression Wire Casing	0	0	7
443	Nipples for Levers on Carburettor, Magneto and $\frac{1}{2}$ " Compression Wire	0	0	$\frac{1}{2}$
444	$\frac{1}{2}$ " Compression Anchor	0	0	3
445	$\frac{1}{2}$ " Compression Strong Spring (top)	0	0	4
446	$\frac{1}{2}$ " Compression Weak Spring (bottom)	0	0	3
447	$\frac{1}{2}$ " Compression Wire Hook	0	0	1

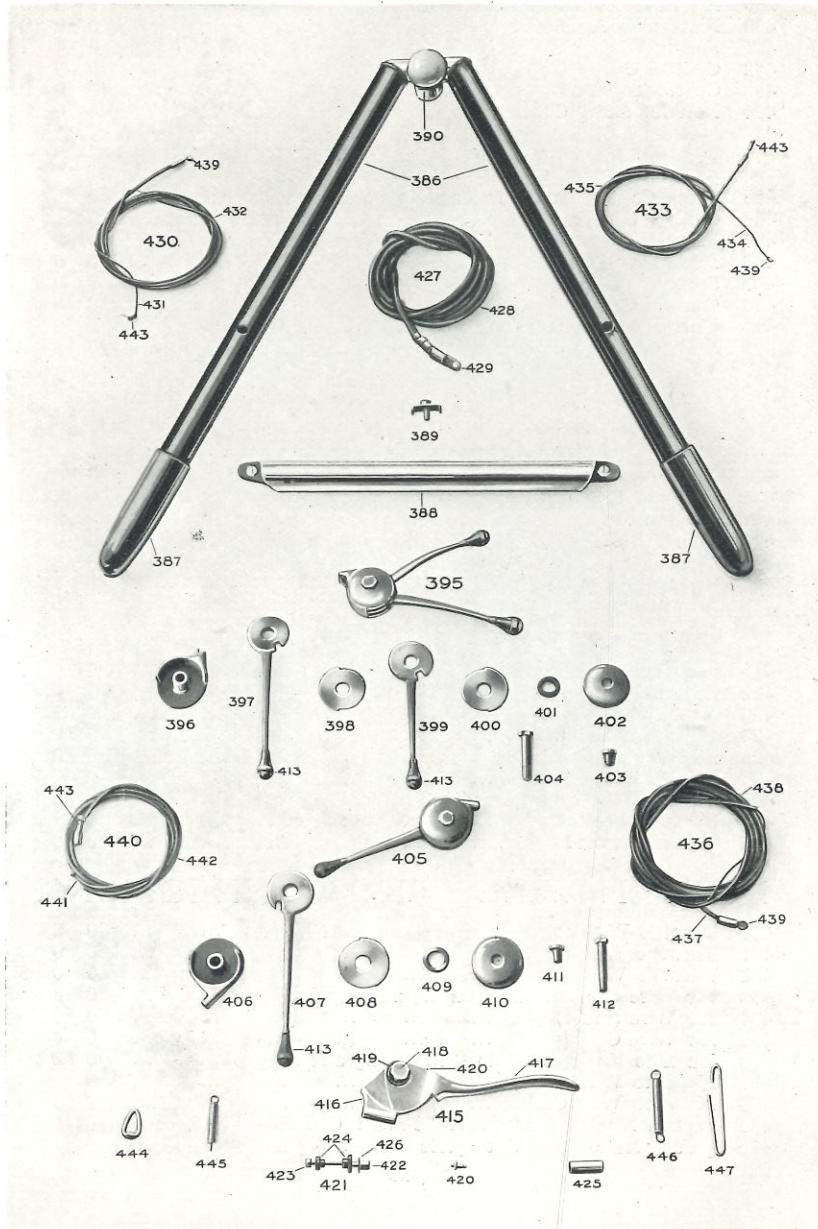

BACK BRAKE.

*450	Back Brake, complete	£0	12	6
451	Brake Pedal	0	2	6
452	Brake Pedal Bolt	0	0	4
453	Brake Pedal Nut	0	0	1
454	L.H. Screwed Rod	0	0	9
455	R.H. Screwed Rod	0	1	3
456	Adjusting Nut	0	0	6
457	Lock Nut	0	0	1
458	Brake Shoe	0	1	6
459	Brake Shoe Distance Piece	0	0	7
460	Brake Block	0	1	3
461	Brake Block Screws	per pair	0	0	2
462	Brake Guide	0	3	0
463	Guide Long Bolt	0	0	3
464	Guide Short Bolt	0	0	2
465	Pull-off Spring	0	0	4
466	Pull-off Spring Clip with Bolt and Nut	0	0	3

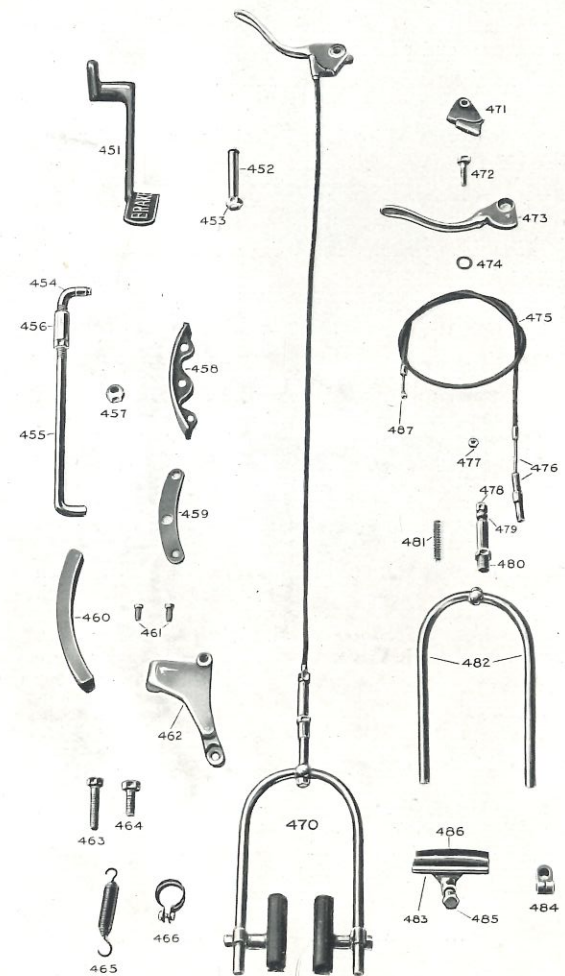

FRONT BRAKE.

470	Front Brake complete	£0 15 0
471	Lever Centre	0 2 6
472	Centre Fixing Bolt	0 0 2
473	Lever	0 1 3
474	Washer	0 0 1
475	Outer Cable	0 1 3
476	Inner Wire complete with Screwed Rod and Nipple	0 1 6
477	Nut for Screwed Rod	0 0 1
478	Adjusting Screw	0 0 4
479	Lock Nut	0 0 1
480	Barrel	0 2 0
481	Pull-off Spring	0 0 3
482	Horseshoe	0 2 0
483	L.H. and R.H. Brake Shoe	each	0 1 6
484	Brake Shoe Clips	each	0 0 8
485	Brake Shoe Bolts	each	0 0 2
486	Brake Blocks	each	0 0 8
487	Nipple on lever end of inner wire	0 0 ½

TANK AND FITTINGS.

*490	Tank complete with Filler Cap, Petrol Tap and Filter and Drain Tap	1 18 6
491	Tank only	1 10 0
492	Screw Filler Cap	0 4 6
493	Screw in Filler Cap	0 0 ½
494	Petrol Tap with Filter complete	0 2 6
495	Petrol Tap only...	0 1 6
496	Filter complete	0 1 0
497	Filter Body	0 0 6
498	Filter Cap with Washer	0 0 2
499	Gauze Filter	0 0 4
500	Drain Tap	0 1 6
501	Petrol or Drain Tap Copper Washers	0 0 ½
502	Petrol Pipe complete with Unions	0 1 9
503	Petrol Pipe only	0 1 4
504	Petrol Pipe Nipples	each	0 0 1
505	Petrol Pipe Unions	each	0 0 3

FOOTBOARDS AND FITTINGS.

510	R.H. or L.H. Footboard, complete	each	0 15 0
511	Board only	each	0 2 0
512	Aluminium Matting	per piece	0 2 0
513	Wire Nails	per set	0 0 2
514	Beading R.H. or L.H. Board	per piece	0 2 0
*515	Screws for 514	per set	0 0 3
516	Back Clip	each	0 4 6
517	Screws for 516	per set	0 0 1
518	C. Springs	each	0 2 6
519	Bolt and Nut for C Springs	each	0 0 2
520	D Tube	0 2 6
521	D Tube Bolt and Nut, Springs, with Cup Washers complete, ea.	each	0 1 8
522	D Tube Bolts and Nuts	each	0 0 6
523	Tension Springs	each	0 0 4
524	Compression Springs	each	0 0 6
525	Cup Washers	each	0 0 1
526	Footboard Rod	0 1 3
527	Hairpins	each	0 0 1

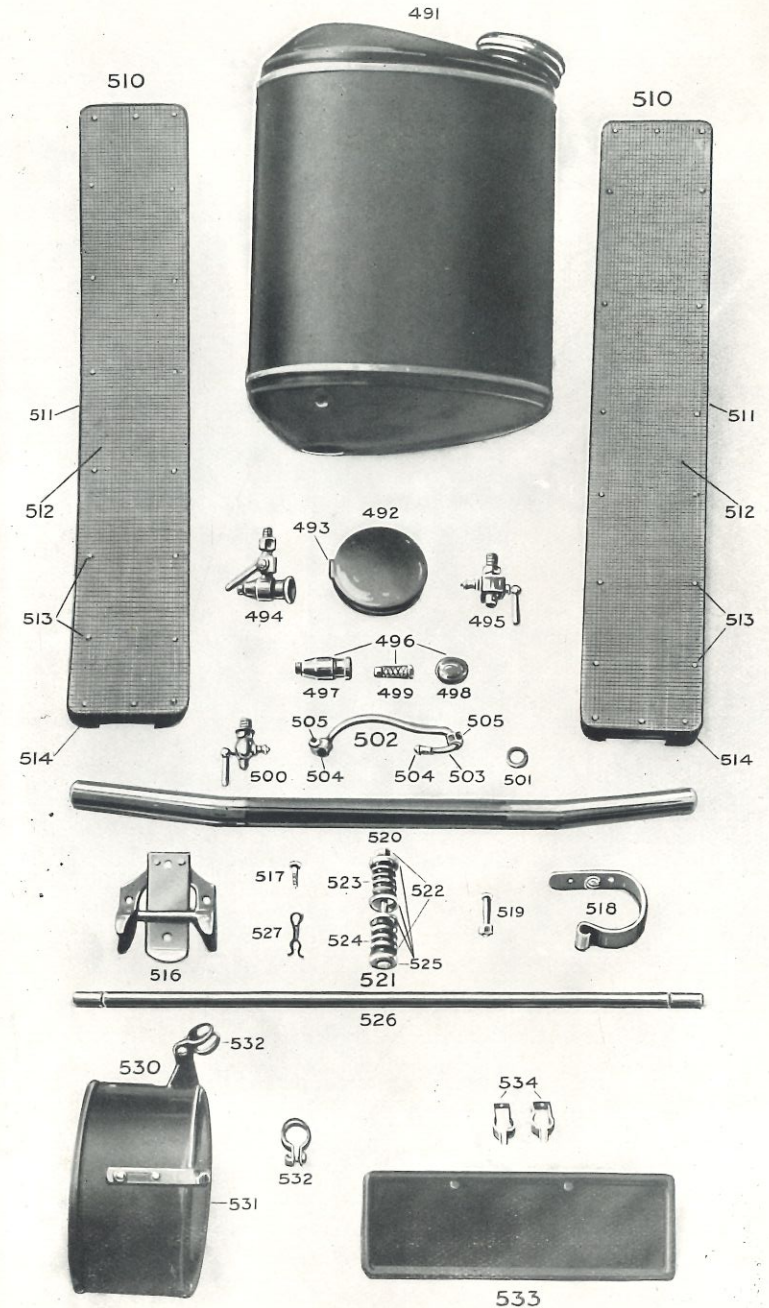

TUBE CASE.

530	Tube Case complete with Clips, Bolts and Nuts	£0	5	0
531	Tube Case only	0	4	6
532	Tube Case Clips with Bolts and Nuts	...	each	0	0	2

BACK No. PLATE.

533	Back Number Plate complete	0	1	6
534	Clips with Rivets	...	each	0	0	1

WIND AND MUD SHIELDS.

540	L.H. or R.H. Wind Shield complete	...	each	0	6	6
541	Wind Shield Bottom Clip	...	each	0	0	6
542	Screwed Wire holding Shield to Radiator	...	each	0	0	1
543	Nipples for 542	...	each	0	0	½
544	Undershield complete	0	4	6
545	Undershield Spring Clip (with Rivets) for D Tube	0	0	9
546	Undershield Spring Clip (with Rivets) for Front Stand	0	0	2
547	Gear Shields	...	per pair	0	8	6
548	Back Chain Guard, complete with Clips	0	2	6
549	Clips with Bolts and Nuts for 548	0	0	2

SADDLE.

550	Saddle complete with Seat Pillar and Oil Filler Cap	1	12	6
551	Saddle only	0	15	0
552	Seat Pillar	0	4	6
553	Seat Pillar Rivets	...	per set of 4	0	1	0
554	Oil Filler Cap	0	5	0
555	Oil Filler Cap Screw	0	0	½
556	R.H. or L.H. Top Bracket	...	each	0	2	6
557	Bottom Bracket	0	5	0
558	Saddle Springs	...	each	0	0	8
559	Saddle Spring Screws	...	each	0	0	1
560	Bracket Bolts and Nuts	...	each	0	0	6

TOOL BAGS AND TOOLS.

565	Tool Bags complete with Clips	...	per pair	0	16	0
566	R.H. or L.H. Tool Bag only	...	each	0	7	6
567	Clips, Plates Bolts and Nuts	...	each	0	0	6
568	Tool Roll complete with Tools	0	11	6
569	Tool Roll only	0	2	0
570	Lock Ring Spanner	0	1	0
571	B.S.A. Spanner	0	1	0
572	Screw Driver	0	0	9
573	Pliers	0	2	0
574	Tyre Lever	0	0	4
575	Large Adjustable Wrench	0	2	6
576	Jet Key	0	1	6
577	Magneto Spanner	0	0	6
578	Petrol Injector	0	1	6
579	Oil Can	0	1	0
580	Tyre Repair Outfit	0	3	0
581	Tyre Inflator	0	3	6
*582	Nail Catcher	0	2	3

TYRES.

*Palmer Cord Ribbed (especially recommended) 26" x 2½"						
	Outer Cover	...	each	2	1	3
	Inner Tube butted	...	each	0	12	0
	Inner Tube plain	...	each	0	10	0

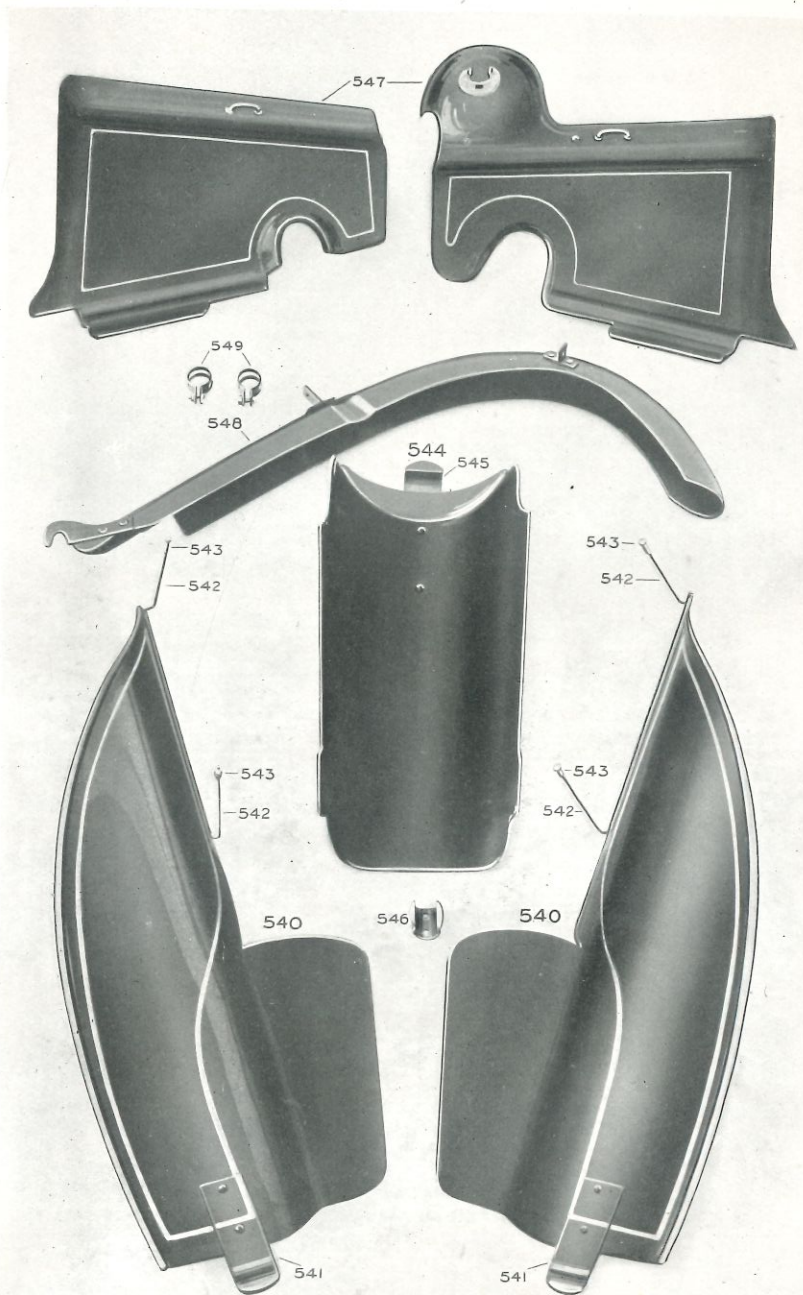

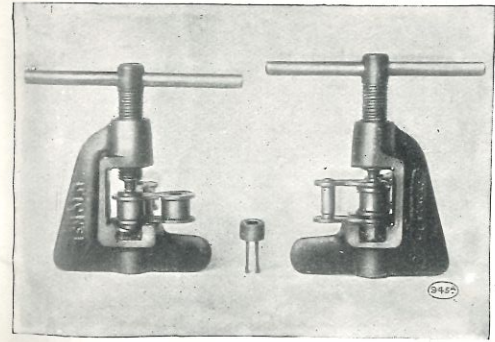
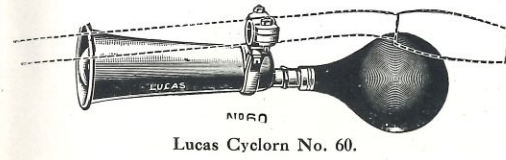
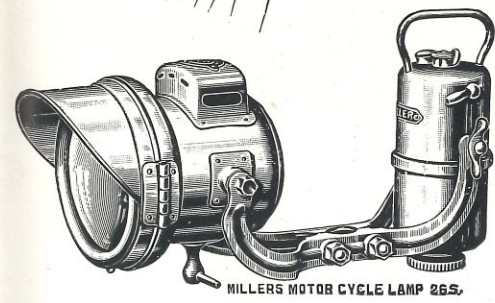
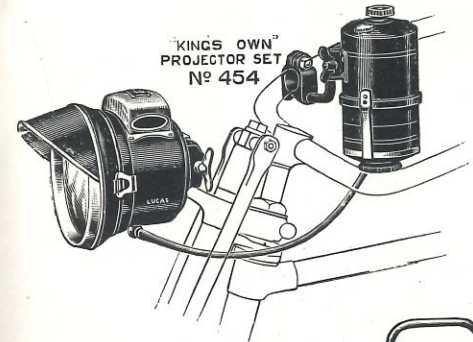
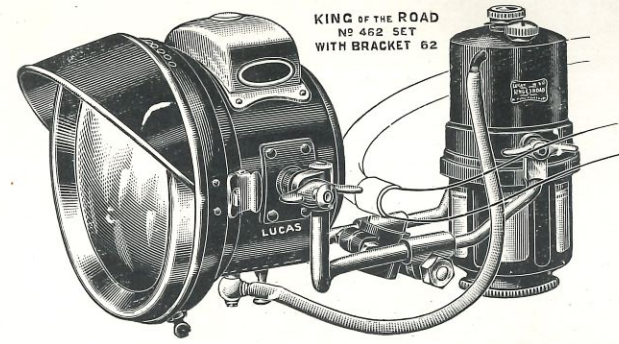
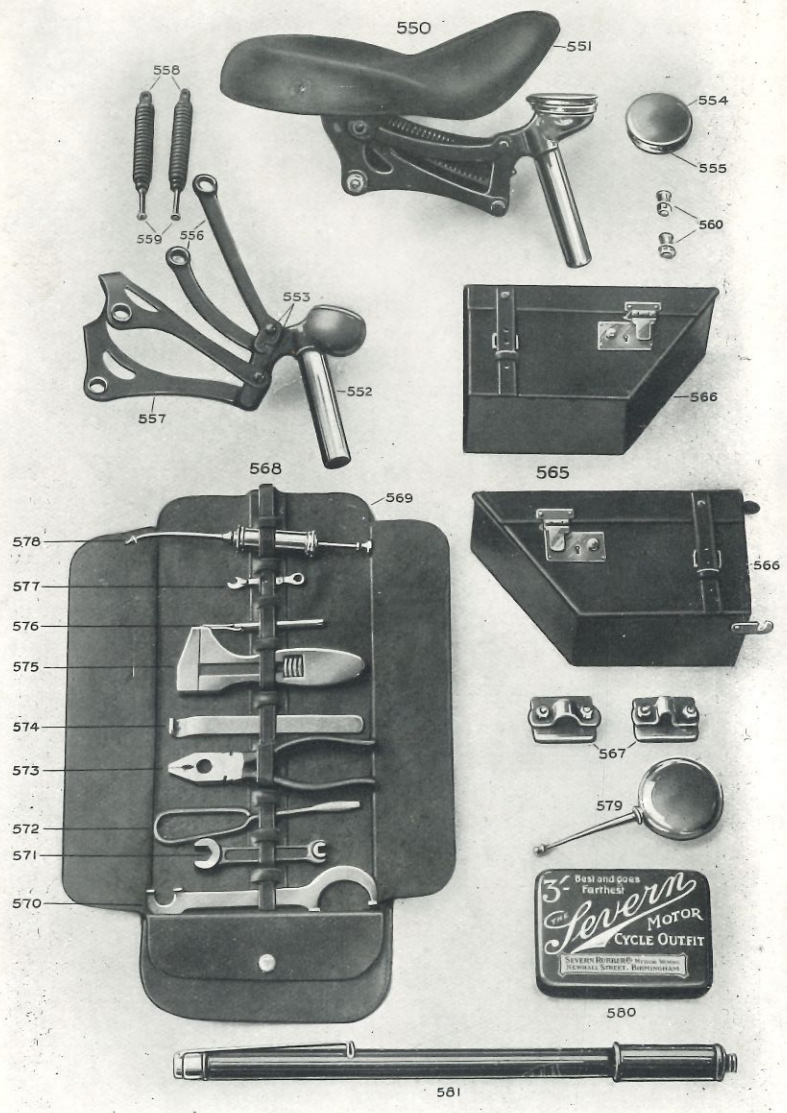

Chain Punch.

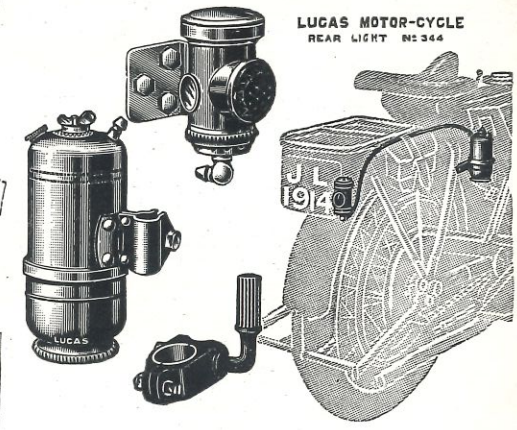
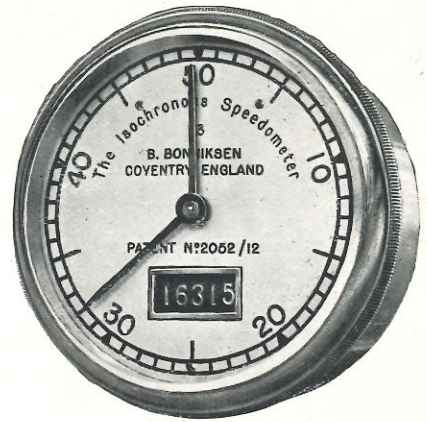

Lucas Acetylene Rear Light.

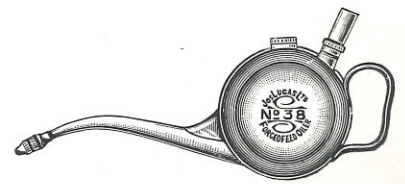

Lucas "Forced Feed" Oiler.

ACCESSORIES (other than Standard Equipment).

Lucas " King of the Road " Projector Set No. 462, with Bracket No. 62 (ebony black or plated)...	£3 0 0
Lucas " King's Own " Projector Set No. 454, with Generator Bracket No. 53 (ebony black or plated)	1 12 6
Miller Searchlight Set No. 26s (ebony black or plated)	1 12 6
The Isochronous Speedometer	4 0 0
Lucas Cyclorn No. 60	0 18 0
Lucas Acetylene Rear Light	0 0 6
*Lucas " Signa " Rear Light	0 2 0
Lucas " Forced Feed " Oiler	0 4 6
*Lucas Observation Mirror	0 7 6
*Lucas " Girder " Major	0 5 6
*Lucas " Girder "	0 2 6
*Lucas " Girder " Minor	0 2 0
*Handlebar Watch (English lever) and Case	1 0 0
*" Scott " Lubricating Oil 10 gal. drum (Drum 5/0 returnable) ... per gal.	0 3 0
" " " 1 gal. tin	0 4 6
" " " ½ gal. tin	0 2 6
" " " 1 quart tin	0 1 6
*" Waterite " (prevents freezing and cures leaking radiators) per tin	0 1 0
*" Scott " Purple Enamel per tin	0 1 6
Chain Punch	0 2 6

OVERHAULING, PLATING, Etc.

Re-building, Re-enamelling and Plating Spokes, Back Wheel	0 10 0
Re-building, Re-enamelling, Re-plating Front Wheel	0 10 0
Re-plating, Re-enamelling complete Machine, not renewing, taking down and re-assembling	5 12 0
Re-enamelling complete Frame	2 0 0
Overhauling Engine, cleaning and rebuilding, not renewing	2 10 0
Re-enamelling and Plating Front Forks	0 12 6
Overhauling and Cleaning Engine Frame, Carburettor, Magneto, Gear, etc., not including any new parts	7 0 0
Overhauling Magneto, adjusting, not renewing	0 7 6
Cleaning, adjusting and rebuilding Gear, not renewing	0 12 6
Re-plating Handle Bars	0 7 6

Replacing or renewing tubes or other parts of frame or forks will be specially quoted for.